

- LEGEND:**
- T000** TREE INVENTORY NUMBER - TREE TO BE PRESERVED/RETAINED
  - T000** TREE INVENTORY NUMBER - TREE TO BE PRESERVED WITH INJURY
  - T000** TREE INVENTORY NUMBER - TREE TO BE REMOVED
  - SURVEYED TREE LOCATION
  - ▲ INDIVIDUAL TREE TO BE PRESERVED WITH INJURY
  - ⊗ INDIVIDUAL TREE TO BE REMOVED DUE TO PROPOSED CONSTRUCTION
  - TREE PROTECTION ZONE (TPZ) FOR TREE LOCATED WITHIN YORK REGIONAL ROAD ALLOWANCE
  - APPROXIMATE DRIPLINE OF TREE CANOPY
  - ▨ ENCROACHMENT WITHIN THE TPZ
  - TREE PRESERVATION FENCE
  - - - PROPERTY BOUNDARY
  - - - TREE INVENTORY BOUNDARY

No.	REVISIONS TO DRAWING	BY	DATE	APPR
1	ISSUED FOR SPA	JD	2025-03-14	PM
0	ISSUED FOR SPA	JD	2024-12-12	PM

ALL PREVIOUS ISSUES OF THIS DRAWING ARE SUPERSEDED

CLIENT  
**COSTCO WHOLESALE**

MUNICIPALITY  
 TOWN OF NEWMARKET

PROJECT TITLE  
 COSTCO BUSINESS CENTRE

SHEET TITLE  
 TREE PRESERVATION PLAN

CONSULTANT  
**wsp**

**ISA** PETER McNAMARA  
 ISA Certified Arborist  
 ON: 11424

DESIGNED	JD	DRAWN	JD	CHECKED	PM
SCALE	1:200	DATE	NOVEMBER 2024		
PROJECT NUMBER	211-07806-00-P01		DATE	NOVEMBER 2024	
DWG. NUMBER	TP1				

**1 TREE PRESERVATION PLAN**  
 1:200

FILE NAME: C:\Users\COAD44\OneDrive\Temp\Newmarket\_Business Centre\_TP\_recovery.dwg; TP-1 PRINTED ON: Wednesday 03/12/2025

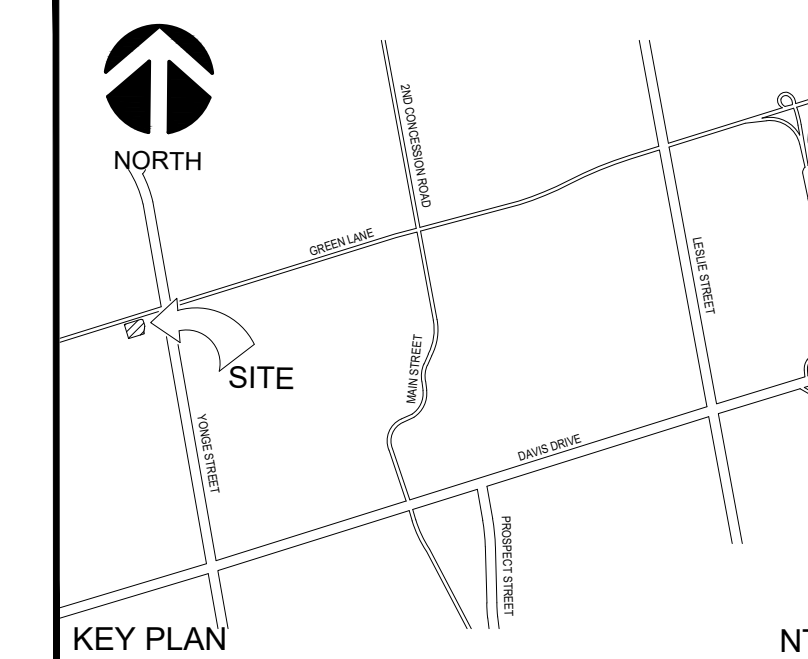

- LEGEND:**
- T000 TREE INVENTORY NUMBER - TREE TO BE PRESERVED/RETAINED
  - T000 TREE INVENTORY NUMBER - TREE TO BE PRESERVED WITH INJURY
  - T000 TREE INVENTORY NUMBER - TREE TO BE REMOVED
  - SURVEYED TREE LOCATION
  - INDIVIDUAL TREE TO BE PRESERVED WITH INJURY
  - INDIVIDUAL TREE TO BE REMOVED DUE TO PROPOSED CONSTRUCTION
  - TREE PROTECTION ZONE (TPZ) FOR TREE LOCATED WITHIN YORK REGIONAL ROAD ALLOWANCE
  - APPROXIMATE DRIPLINE OF TREE CANOPY
  - ENCROACHMENT WITHIN THE TPZ
  - TREE PRESERVATION FENCE
  - PROPERTY BOUNDARY
  - TREE INVENTORY BOUNDARY

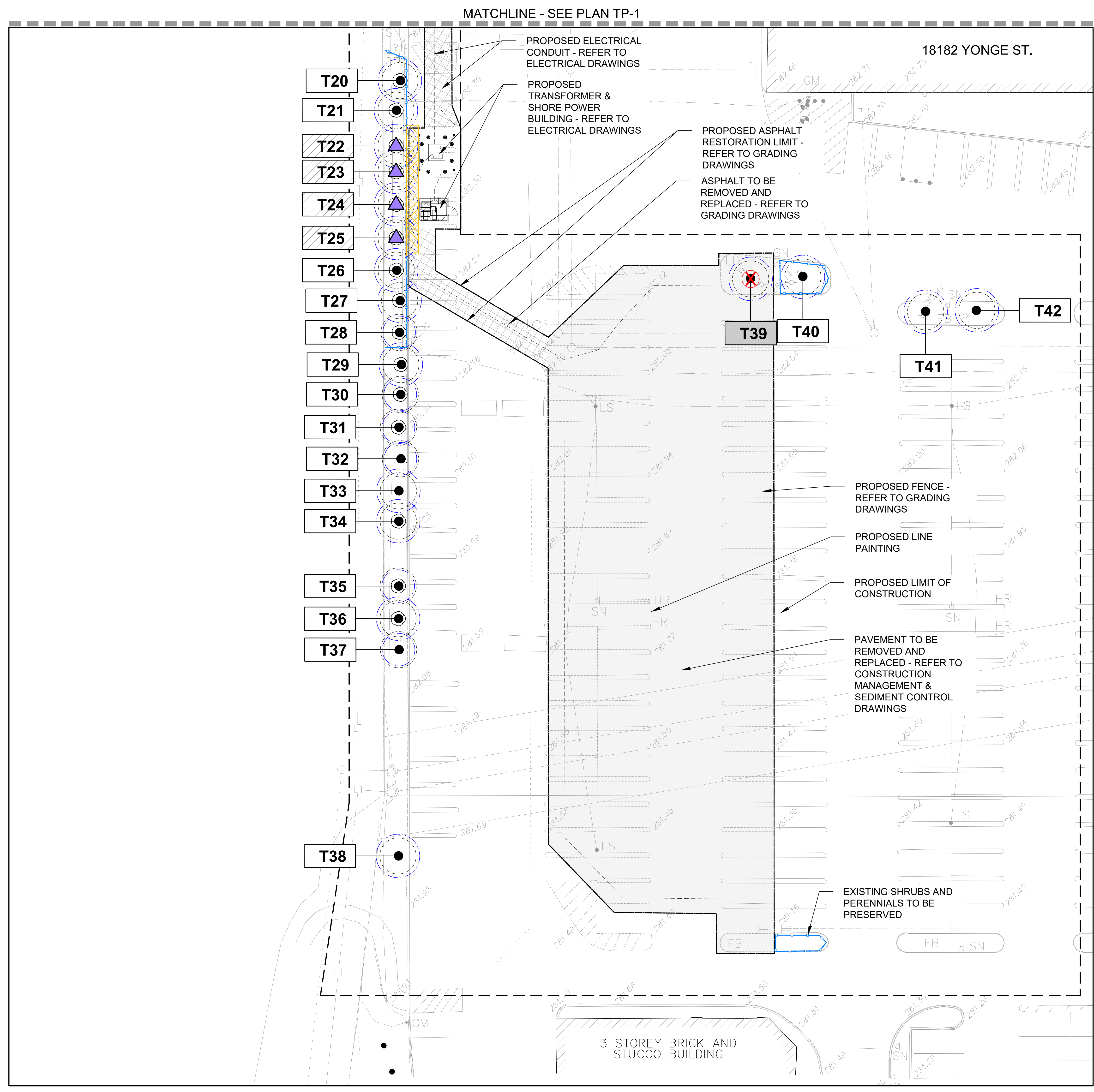

**2 TREE PRESERVATION PLAN**  
1:200

No.	REVISIONS TO DRAWING	BY	DATE	APPR
1	ISSUED FOR SPA	JD	2025-03-14	PM
0	ISSUED FOR SPA	JD	2024-12-12	PM

ALL PREVIOUS ISSUES OF THIS DRAWING ARE SUPERSEDED

CLIENT  
**COSTCO WHOLESALE**

MUNICIPALITY  
TOWN OF NEWMARKET

PROJECT TITLE  
COSTCO BUSINESS CENTRE

SHEET TITLE  
TREE PRESERVATION PLAN

CONSULTANT  
**wsp**

PETER McNAMARA  
ISA Certified Arborist  
ON: 11424

DESIGNED	JD	DRAWN	JD	CHECKED	PM
SCALE	1:200	DATE	NOVEMBER 2024		
PROJECT NUMBER	211-07806-00-P01		DWG. NUMBER	TP2	

FILE NAME: C:\Users\CA04041\MyPapers\Local\Temp\McNamara\211786\Newmarket\_Business\_Centre\_TP\_recover.dwg; TP-2 PRINTED ON: Wednesday, 03/12/2025

Tree #	Botanical Name	Common Name	Qty	DBH (cm)	Tree Condition			Dripline Radius (m)	Tree Location / Applicable By-law	Address	Tree Protection Zone	Recommendation	Comments - Removal / Preservation
					TI	CS	CV						
<b>Costco Wholesale - 18182 Yonge St. Newmarket</b>													
T1	<i>Picea pungens</i>	Blue Spruce	1	31	G	G	G-F	3.5	Private	18182 Yonge St.	2.4	Preserve - TPZ Encroachment w/ no Injury	Lower deadwood approx. 15%. Pruned from light pole.
T2	<i>Picea pungens</i>	Blue Spruce	1	31	G	G	G	3.5	Private	18182 Yonge St.	2.4	Preserve - TPZ Encroachment w/ no Injury	
T3	<i>Picea pungens</i>	Blue Spruce	1	32	G	F	F	3.5	Private	18182 Yonge St.	2.4	Preserve - TPZ Encroachment w/ no Injury	Deadwood approx. 15-20%. Brown needles. Secondary, smaller leader.
T4	<i>Quercus robur 'fastigiata'</i>	Columnar Oak	1	22	G	G	G	3.0	Private	18182 Yonge St.	2.4	Preserve - TPZ Encroachment w/ no Injury	Multi-stemmed at base.
T5	<i>Quercus robur 'fastigiata'</i>	Columnar Oak	1	19	G	G	G	3.0	Private	18182 Yonge St.	2.4	Preserve - TPZ Encroachment w/ no Injury	
T6	<i>Acer rubrum</i>	Red Maple	1	5	F	F	G	2.0	Private	18182 Yonge St.	1.8	Preserve - TPZ Encroachment w/ no Injury	Injury at base. Witches Broom.
T7	<i>Acer rubrum</i>	Red Maple	1	5	G	F	G	2.0	Private	18182 Yonge St.	1.8	Preserve - TPZ Encroachment w/ no Injury	Witches Broom.
T8	<i>Acer rubrum</i>	Red Maple	1	5	G-F	F	G	2.0	Private	18182 Yonge St.	1.8	Preserve - TPZ Encroachment w/ no Injury	Buried root flare.
T9	<i>Quercus robur 'fastigiata'</i>	Columnar Oak	1	17	G	G	G	2.5	Private	18182 Yonge St.	2.4	Preserve - TPZ Encroachment w/ no Injury	
T10	<i>Quercus robur 'fastigiata'</i>	Columnar Oak	1	18,15	G	G	G	2.5	Private	18182 Yonge St.	2.4	Preserve - TPZ Encroachment w/ no Injury	
T11	<i>Quercus robur 'fastigiata'</i>	Columnar Oak	1	22	G	G	G	2	Private	18182 Yonge St.	2.4	Preserve - TPZ Encroachment w/ no Injury	
T12	<i>Quercus robur 'fastigiata'</i>	Columnar Oak	1	7	G	G	G	1.5	Private	18182 Yonge St.	1.8	Remove	Buried root flare.
T13	<i>Quercus robur 'fastigiata'</i>	Columnar Oak	1	7	G	G	G	1.5	Private	18182 Yonge St.	1.8	Remove	Buried root flare.
T14	<i>Quercus robur 'fastigiata'</i>	Columnar Oak	1	6	G	G	G	1.5	Private	18182 Yonge St.	1.8	Remove	Buried root flare.
T15	<i>Quercus robur 'fastigiata'</i>	Columnar Oak	1	6	G	G	G	1.5	Private	18182 Yonge St.	1.8	Remove	Buried root flare.
T16	<i>Quercus robur 'fastigiata'</i>	Columnar Oak	1	22	G	G	G	2.5	Private	18182 Yonge St.	2.4	Preserve - TPZ Encroachment w/ no Injury	
T17	<i>Quercus robur 'fastigiata'</i>	Columnar Oak	1	15,10	G	G	G	2.5	Private	18182 Yonge St.	2.4	Preserve - TPZ Encroachment w/ no Injury	
T18	<i>Quercus robur 'fastigiata'</i>	Columnar Oak	1	19	G	G	G	2	Private	18182 Yonge St.	2.4	Preserve - TPZ Encroachment w/ no Injury	
T19	<i>Quercus robur 'fastigiata'</i>	Columnar Oak	1	19	G	G	G	2	Private	18182 Yonge St.	2.4	Preserve - TPZ Encroachment w/ no Injury	
T20	<i>Quercus robur 'fastigiata'</i>	Columnar Oak	1	15,11	G	G	G	2	Private	18182 Yonge St.	2.4	Preserve - TPZ Encroachment w/ no Injury	Multiple leaders.
T21	<i>Quercus robur 'fastigiata'</i>	Columnar Oak	1	16	G	G	G	2	Private	18182 Yonge St.	2.4	Preserve - TPZ Encroachment w/ no Injury	Deadwood approx. 10%
T22	<i>Quercus robur 'fastigiata'</i>	Columnar Oak	1	18	G	G	G	2	Private	18182 Yonge St.	2.4	Preserve - With injury	Injury will be mitigated through air-spade mitigation.
T23	<i>Quercus robur 'fastigiata'</i>	Columnar Oak	1	16	G	G	G	2	Private	18182 Yonge St.	2.4	Preserve - With injury	Deadwood approx. 10%. Injury will be mitigated through air-spade mitigation.
T24	<i>Quercus robur 'fastigiata'</i>	Columnar Oak	1	10,8,8	G	G	G	2	Private	18182 Yonge St.	2.4	Preserve - With injury	Injury will be mitigated through air-spade mitigation.
T25	<i>Quercus robur 'fastigiata'</i>	Columnar Oak	1	10,10	G	G	G	2	Private	18182 Yonge St.	2.4	Preserve - With injury	Deadwood approx. 10%. Injury will be mitigated through air-spade mitigation.
T26	<i>Quercus robur 'fastigiata'</i>	Columnar Oak	1	12	G	G	G	2	Private	18182 Yonge St.	2.4	Preserve - TPZ Encroachment w/ no Injury	Deadwood approx. 5%
T27	<i>Quercus robur 'fastigiata'</i>	Columnar Oak	1	10,10,9	G	G	G	2	Private	18182 Yonge St.	2.4	Preserve - TPZ Encroachment w/ no Injury	
T28	<i>Quercus robur 'fastigiata'</i>	Columnar Oak	1	9,8,8	G	G	G	2	Private	18182 Yonge St.	1.8	Preserve	Full TPZ to be preserved.
T29	<i>Quercus robur 'fastigiata'</i>	Columnar Oak	1	12,10	G	G-F	G	2	Private	18182 Yonge St.	2.4	Retain	Small broken limbs lower canopy.
T30	<i>Quercus robur 'fastigiata'</i>	Columnar Oak	1	9,7	G	G	G	2	Private	18182 Yonge St.	1.8	Retain	
T31	<i>Quercus robur 'fastigiata'</i>	Columnar Oak	1	10	G	G	G	2	Private	18182 Yonge St.	1.8	Retain	Lower canopy pruned from parking.
T32	<i>Quercus robur 'fastigiata'</i>	Columnar Oak	1	9,9,8	G	G	G	2	Private	18182 Yonge St.	1.8	Retain	Lower canopy pruned from parking.
T33	<i>Quercus robur 'fastigiata'</i>	Columnar Oak	1	11,9,9	G	G	G	2	Private	18182 Yonge St.	2.4	Retain	
T34	<i>Quercus robur 'fastigiata'</i>	Columnar Oak	1	11	G	G	G-F	2	Private	18182 Yonge St.	2.4	Retain	Deadwood approx. 15%. Canopy thinner than others.
T35	<i>Quercus robur 'fastigiata'</i>	Columnar Oak	1	9,9,9	G-F	G	G	2	Private	18182 Yonge St.	1.8	Retain	Injury lower trunk.
T36	<i>Quercus robur 'fastigiata'</i>	Columnar Oak	1	15,10	G	G	G	2	Private	18182 Yonge St.	2.4	Retain	
T37	<i>Quercus robur 'fastigiata'</i>	Columnar Oak	1	10	G	G	G	2	Private	18182 Yonge St.	1.8	Retain	Pruned from parking.
T38	<i>Acer rubrum</i>	Red Maple	1	13	G-F	G	F	2	Private	18182 Yonge St.	2.4	Retain	20% deadwood. Decay at base.
T39	<i>Gleditsia tricanthos</i>	Honey Locust	1	13	G	G	G	2	Private	18182 Yonge St.	2.4	Remove	Small injury mid-trunk.
T40	<i>Gleditsia tricanthos</i>	Honey Locust	1	12	G	G-F	G	2	Private	18182 Yonge St.	2.4	Preserve	Full TPZ to be preserved.
T41	<i>Gleditsia tricanthos</i>	Honey Locust	1	11	G	G	G	2	Private	18182 Yonge St.	2.4	Retain	Root flare present.
T42	<i>Gleditsia tricanthos</i>	Honey Locust	1	11	G	G	G	2	Private	18182 Yonge St.	2.4	Retain	Root flare present.
<b>Costco Wholesale - Green Lane West, Newmarket</b>													
T43	<i>Acer tataricum</i>	Tatarian Maple	1	5	G	G	G	1.5	Region	Green Ln. W	2.4	Preserve - With injury	Injury will be mitigated through air-spade mitigation.
T44	<i>Acer tataricum</i>	Tatarian Maple	1	6	G	G	G	1.5	Region	Green Ln. W	2.4	Preserve - With injury	Injury will be mitigated through air-spade mitigation.
T45	<i>Acer tataricum</i>	Tatarian Maple	1	5	G	G	G	1.5	Region	Green Ln. W	2.4	Preserve - With injury	Injury will be mitigated through air-spade mitigation.

**TREE PRESERVATION TABLE COLOUR LEGEND**

- TREE TO BE RETAINED
- TREE TO BE PRESERVED
- TREE TO BE PRESERVED - TPZ ENCROACHMENT WITH NO INJURY
- TREE TO BE PRESERVED - TPZ ENCROACHMENT WITH INJURY
- TREE TO BE REMOVED

**TREE PRESERVATION TABLE LEGEND**

Tree Assessment Criteria:

**Trunk Integrity (T.I.):** this is an assessment of the trunk for any defects or weaknesses. It is measured on a scale of poor, fair, good.

**Canopy Structure (C.S.):** this is an assessment of the scaffold branches, unions and the canopy of the tree. This is measured on a scale of poor, fair, good.

**Canopy Vigour (C.V.):** this is an assessment of the health of the tree and assesses the amount of deadwood and the live growth in the crown as compared to a 100% healthy tree. The size, colour and amount of foliage are also considered in this category. This is measured on a scale of poor, fair, good.

Tree Condition:

**G:** Good - tree displays less than 15% deficiency / defect within the given tree assessment criteria (T.I, C.S, C.V)

**F:** Fair - tree displays 15-50% deficiency / defect within the given tree assessment criteria (T.I, C.S, C.V)

**P:** Poor - tree displays greater than 40% deficiency / defect within the given tree assessment criteria (T.I, C.S, C.V)

**D:** Dead - tree displays 100% deficiency / defect within the canopy vigour tree assessment criteria

Recommendation:

**Retain:** tree is in good condition and will not be impacted by construction / grading as the tree is more than 6m from the limits of work.

**Remove:** tree is either in poor condition or dead or will be significantly impacted by grading and construction limits and will not survive.

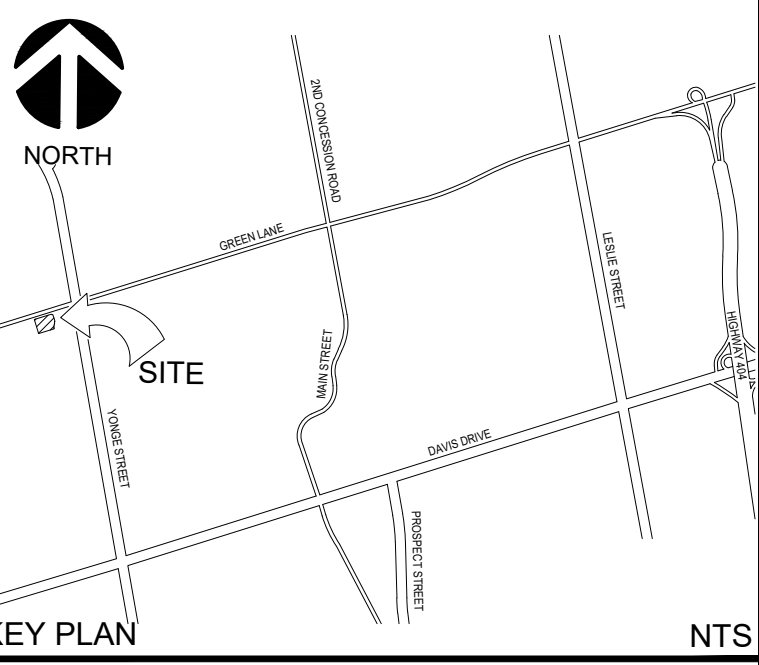

KEY PLAN NTS

1	ISSUED FOR SPA	JD	2025-03-14	PM
0	ISSUED FOR SPA	JD	2024-12-12	PM
No.	REVISIONS TO DRAWING	BY	DATE	APPR

ALL PREVIOUS ISSUES OF THIS DRAWING ARE SUPERSEDED



MUNICIPALITY: TOWN OF NEWMARKET

PROJECT TITLE: COSTCO BUSINESS CENTRE

SHEET TITLE: TREE PRESERVATION TABLES

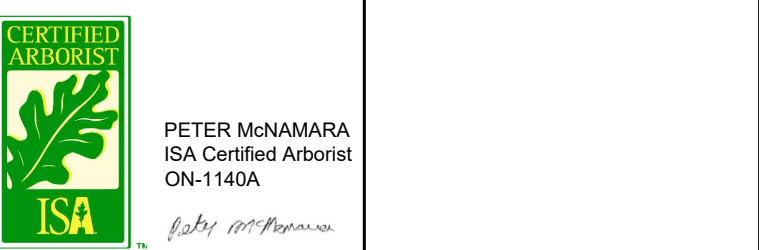

DESIGNED	JD	DRAWN	JD	CHECKED	PM
SCALE	1:200	DATE	NOVEMBER 2024	PROJECT NUMBER	DWG. NUMBER
211-07806-00-P01				TP3	



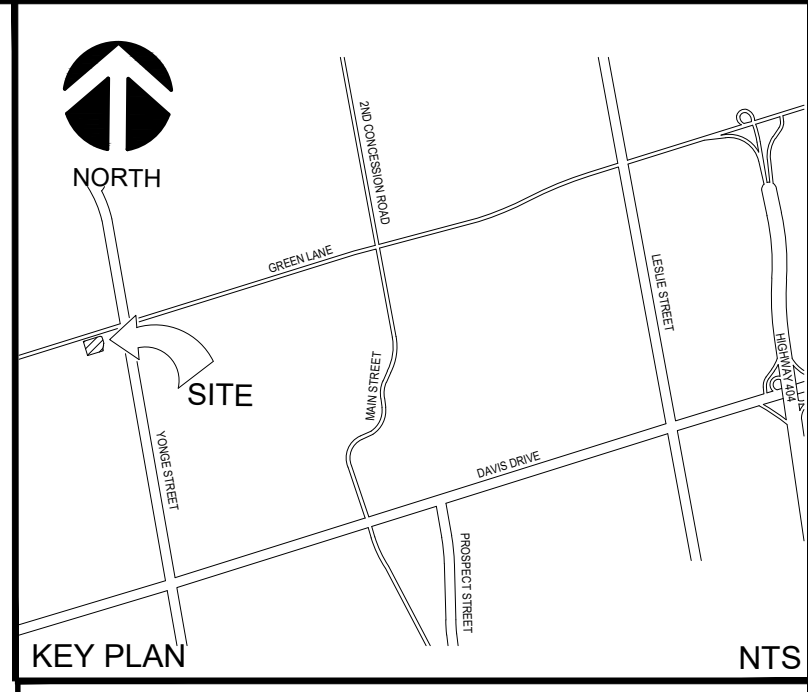

### TREE PROTECTION ZONE (TPZ)

**PLEASE NOTE THAT ANY:  
GRADE CHANGE  
DUMPING  
STORAGE  
UNAUTHORIZED ENTRY  
TREE INJURY OR REMOVAL  
DISTURBANCE OF ANY KIND  
IS STRICTLY PROHIBITED WITHIN THIS TPZ**

**THIS BARRIER SHALL NOT BE DAMAGED OR MOVED**

**PLEASE REPORT ANY ENTRY INTO THIS ZONE  
TO NATURAL HERITAGE AND FORESTRY:**

Access York -  
1-877-464-9675 ext. 73000  
accessyork@york.ca

Environmental Services

#### TREE PROTECTION ZONE (TPZ) SIGNAGE

DATE: JANUARY 2022	SCALE: N.T.S.
REV. X X	NHF - 401

**NOTES**

- REFER TO YORK REGION STREET TREE AND FOREST PRESERVATION GUIDELINES FOR COMPLETE TREE PRESERVATION REQUIREMENTS.
- TPZ SIGNAGE SHALL BE INSTALLED ON AT LEAST TWO SIDES OF THE TPZ BARRIER WITH DISTANCE BETWEEN SIGNS NOT TO EXCEED 10 METRES ON ANY ONE SIDE.

**General**

- York Region Street Tree and Forest Preservation Guidelines (the "Guidelines") must be implemented where site disturbance is proposed in the Regional road allowance and any Region-owned street trees and/or natural vegetation within 10m or less of the front of proposed site disturbance.
- These Guidelines must also be implemented where site disturbance is proposed outside of the Regional road allowance and Region-owned street trees and/or natural vegetation are situated within 10m of the front of potential site disturbance and/or where Region-owned street trees and/or natural vegetation are situated more than 10m but may be adversely impacted by the proposed site disturbance.
- All tree preservation measures shall be in accordance with the Guidelines.
- All proposed tree preservation measures must be described in the Arborist Report and shown on the Tree Protection Plan and approved by York Region Environmental Services Department, Natural Heritage and Forestry in accordance with the Guidelines for tree inventory, tree removal, transplantation and other requirements.
- All tree protection zone barriers shall be installed prior to any site disturbance, including tree removal, and must remain in good repair for the duration of any site disturbance.
- All the site disturbance of York Region Natural Heritage and Forestry, any existing trees that die or exhibit a decline in health prior to final acceptance shall be compensated for in accordance with the Guidelines.
- York Region Natural Heritage and Forestry shall be notified when tree protection measures have been installed and before tree removal, if applicable.

**Tree Protection Zone (TPZ)**

- A minimum Tree Protection Zone (TPZ) will be established around every tree to be preserved in accordance with the Guidelines and a York Region-approved Tree Protection Plan.
- No entry or activity shall be permitted within the TPZ without prior written approval of York Region Natural Heritage and Forestry.
- Prohibited activities within the TPZ include but are not limited to installation or attachment of any items to the tree, operation of equipment or machinery, storage of equipment or materials, access by any personnel, placement of trailers, temporary buildings or structures, dumping, storage or dumping of fuels, chemicals or other contaminants, stockpiling of soil, digging, trenching, or excavation, and/or change to existing grade.
- Permitted activities within the TPZ with prior written approval of York Region Natural Heritage and Forestry and consent by a qualified tree professional include but are not limited to: encroachment activities related to tree protection provisions such as canopy clearance pruning, root-sensitive excavation and soil grading, tree stem protection and other arboricultural maintenance.

**Tree Protection Zone (TPZ) Barrier**

- A Tree Protection Zone (TPZ) barrier shall be constructed around the TPZ of every tree to be preserved in accordance with the Guidelines and a York Region-approved Tree Protection Plan. The TPZ barrier shall follow York Region standard drawing Tree Protection Zone (TPZ) Barrier NHF-402.
- Where trees to be protected are located in close proximity to each other, the TPZ barrier shall be installed to protect trees in contiguous groups.
- The TPZ barrier shall be constructed of 2x4 framing. The height of the frame shall measure a minimum of 1.2m (4 feet), and the width of individual frame sections shall not exceed 2.4m (8 feet).
- The frame shall be supported by diagonal 2x4 support legs installed inside the TPZ, secured to the frame using wood screws, and secured to the ground using a wooden stake installed a minimum of 125mm into the ground. A minimum of 1 support leg shall be installed per 2.4m (8 feet) of linear TPZ barrier distance, or per frame section.
- Formed construction fencing is the primary method for TPZ barrier construction. Orange construction safety fencing shall be securely and tightly attached to the outside of the TPZ barrier frame to construct the frame using wood screws, and secured to the ground using a wooden stake installed a minimum of 125mm into the ground. A minimum of 1 support leg shall be installed per 2.4m (8 feet) of linear TPZ barrier distance, or per frame section. Other fencing materials (e.g., chain-link, green snow fence) shall not be used.
- Soil boarding shall be installed where there is a significant risk of fill or other material being piled against the TPZ barrier, or where heavy machinery is to be operated in close proximity to the TPZ barrier. Plywood or oriented strand board (OSB) sheathing with a minimum thickness of 5/8" shall be affixed using wood screws to the outside of the TPZ barrier frame to construct the solid boarding TPZ barrier type. Nails, staples or other fasteners shall not be used.
- If required, and as approved in the Arborist Report, all barrier fencing shall be installed using a "no-dig" method as described in the Guidelines.

**Tree Protection Zone (TPZ) Signage**

- All Tree Protection Zone (TPZ) signage shall be in accordance with the Guidelines.
- Signage shall follow York Region standard drawing Tree Protection Zone (TPZ) Signage NHF-401 and shall be installed on at least two sides of the TPZ barrier. The distance between individual signs shall not exceed 10m on any one side of the TPZ barrier.

**Maintenance and Inspection**

- TPZ barriers shall remain in place and in good working order and appearance throughout the duration of site disturbance until completion of all works.
- TPZ barriers shall not be moved, modified, or relocated at any time without the approval of York Region or its designee.
- TPZ barriers shall be inspected by a qualified tree professional once weekly or on a schedule approved by York Region or its designee. Any deficiencies shall be noted in writing and any TPZ barriers found to be in substandard condition shall be repaired, modified or replaced as necessary within 48 hours of lowest notification by York Region or its designee.

**Encroachment**

- All encroachment work shall be in accordance with the Guidelines and a York Region-approved Tree Protection Plan and Arborist Report.
- A qualified tree professional must be present for all encroachment work within the TPZ.
- York Region Natural Heritage and Forestry shall be notified with 24 hours of notice prior to work occurring within the TPZ.
- TPZ barriers shall be placed at the field of encroachment and not be moved at any time during construction unless under the supervision of a qualified tree professional.
- Below-grade encroachment: root sensitive excavation and root pruning shall be undertaken prior to construction or excavation in per standard drawing NHF-403.
- At-grade encroachment: root zone compaction protection provisions must be followed as per standard drawing NHF-404.
- After the completion of construction, soil compaction and restoration provisions shall be followed when deemed necessary by York Region Natural Heritage and Forestry.

**Pruning**

- All pruning work shall be in accordance with the Guidelines and a York Region-approved Tree Protection Plan and Arborist Report.
- No tree branches or tree roots shall be pruned without written approval of York Region or its designee.
- Approved pruning must follow arboriculture best practices and be undertaken by an ISA Certified Arborist or an Ontario College of Trades AAAA Arborist or Arborist Apprentice only.
- No other trades personnel are permitted to prune tree branches or tree roots.

**Other**

- Other tree preservation measures may be required to be implemented wherever site disturbance is proposed anticipated to occur within or in close proximity to Tree Protection Zone (TPZ) and trees to be preserved. Other acceptable tree preservation measures are described in the Guidelines.

#### STANDARD TREE PROTECTION NOTES

DATE: JANUARY 2022	SCALE: N.T.S.
REV. X X	NHF - 402

**STAKE DETAIL**

**NOTES**

- REFER TO YORK REGION STREET TREE AND FOREST PRESERVATION GUIDELINES FOR COMPLETE TREE PRESERVATION REQUIREMENTS.
- TREE PROTECTION ZONE (TPZ) BARRIERS SHALL BE INSTALLED AT THE OUTER LIMIT OF THE MINIMUM REQUIRED TPZ FOR EACH TREE TO BE PRESERVED AND OR AS DIRECTED IN THE APPROVED TREE PROTECTION PLAN BY YORK REGION NATURAL HERITAGE AND FORESTRY.
- TPZ BARRIERS SHALL BE CALIBRATED AS A RADIUS IN METRES MEASURED OUTWARD FROM THE BASE OF THE TREE TO BE PROTECTED. THE TPZ RADIUS IS DETERMINED BASED UPON THE DIAMETER AT BREAST HEIGHT (DBH) OF THE TREE MAIN STEM FOR ALL MATURED TREES. THE DIAMETER OF THE MAIN STEM OF STEMS OF A TREE ARE MEASURED IN CENTIMETRES AT 30cm ABOVE GRADE LEVEL. THE TPZ FOR ALL TREES 25cm DBH OR LESS IS A MINIMUM OF 2.4m. THE TPZ FOR TREES 25cm OR GREATER IS 10m FOR EVERY CENTIMETRE OF DBH.
- TPZ BARRIERS SHALL PROTECT CONTIGUOUS GROUPS OF TREES WHEREVER POSSIBLE.
- TPZ BARRIERS SHALL BE ESTABLISHED, INSPECTED, AND APPROVED BY YORK REGION OR ITS DESIGNATE PRIOR TO COMMENCEMENT OF ANY TREE DISTURBANCE.
- TPZ BARRIERS SHALL BE INSPECTED BY A QUALIFIED TREE PROFESSIONAL ONCE WEEKLY OR ON A SCHEDULE APPROVED BY THE YORK REGION OR ITS DESIGNATE.
- TPZ BARRIERS SHALL NOT BE MOVED, MODIFIED, OR RELOCATED AT ANY TIME WITHOUT PRIOR APPROVAL OF YORK REGION OR ITS DESIGNATE.

**PLAN VIEW**

#### TREE PROTECTION ZONE (TPZ) BARRIER

DATE: JANUARY 2022	SCALE: N.T.S.
REV. X X	NHF - 400

**LIGHT ROOT ZONE COMPACTION PROTECTION**

LIGHT ROOT ZONE COMPACTION PROTECTION SHALL BE IMPLEMENTED WHERE LIMITED NON-VEHICULAR ACCESS IN THE TPZ IS ANTICIPATED (E.G., OCCASIONAL FOOT TRAFFIC, WHEELBARROW).

**MODERATE ROOT ZONE COMPACTION PROTECTION**

MODERATE ROOT ZONE COMPACTION PROTECTION SHALL BE IMPLEMENTED WHERE MORE FREQUENT NON-VEHICULAR ACCESS OR OCCASIONAL LIGHT VEHICLE (E.G. PICKUP, TRUCK) ACCESS ACROSS THE TPZ IS ANTICIPATED.

**HEAVY ROOT ZONE COMPACTION PROTECTION**

HEAVY ROOT ZONE COMPACTION PROTECTION SHALL BE IMPLEMENTED IN AREAS WHERE REGULAR VEHICLE ACCESS OR SIMILAR IMPACTS ARE ANTICIPATED IN THE TPZ.

**NOTES**

- REFER TO YORK REGION STREET TREE AND FOREST PRESERVATION GUIDELINES FOR COMPLETE TREE PRESERVATION REQUIREMENTS.
- ANY TPZ BARRIER ENCROACHMENT MUST BE PERMITTED IN WRITING BY YORK REGION OR ITS DESIGNATE.

#### ROOT ZONE COMPACTION PROTECTION

DATE: JANUARY 2022	SCALE: N.T.S.
REV. X X	NHF - 404

**NOTES**

- REFER TO YORK REGION STREET TREE AND FOREST PRESERVATION GUIDELINES FOR COMPLETE TREE PRESERVATION REQUIREMENTS.
- TREE STEM PROTECTION SHALL ONLY BE INSTALLED WHERE TPZ ENCROACHMENT IS APPROVED IN WRITING BY YORK REGION OR ITS DESIGNATE AND WHERE THERE IS A REASONABLE POSSIBILITY OF ACCIDENTAL IMPACT UPON THE MAIN STEM OR SCAFFOLD BRANCHES OF A TREE TO BE PRESERVED.

#### TREE STEM PROTECTION

DATE: JANUARY 2022	SCALE: N.T.S.
REV. X X	NHF - 405

**1. EXISTING CONDITIONS (TYP.)**

**2. ROOT-SENSITIVE EXCAVATION (TYP.)**

**3. ROOT PRUNING (TYP.)**

**4. CONVENTIONAL EXCAVATION (TYP.)**

**NOTES**

- REFER TO YORK REGION STREET TREE AND FOREST PRESERVATION GUIDELINES FOR COMPLETE TREE PRESERVATION REQUIREMENTS.
- NO ROOTS GREATER THAN 65mm SHALL BE PRUNED WITHOUT AUTHORIZATION OF YORK REGION OR ITS DESIGNATE.
- PROLONGED EXPOSURE OF TREE ROOTS MUST BE AVOIDED.
- ROOT-SENSITIVE EXCAVATION AND ROOT PRUNING SHALL BE COMPLETED BY A QUALIFIED TREE PROFESSIONAL WITH PRIOR WRITTEN APPROVAL BY YORK REGION OR ITS DESIGNATE.
- UPON COMPLETION, DOCUMENTATION OF THESE ACTIVITIES SHALL BE SUBMITTED TO YORK REGION.

#### ROOT-SENSITIVE EXCAVATION AND ROOT PRUNING

DATE: JANUARY 2022	SCALE: N.T.S.
REV. X X	NHF - 403

ALL PREVIOUS ISSUES OF THIS DRAWING ARE SUPERSEDED			
<b>COSTCO WHOLESALE</b>			
MUNICIPALITY <b>TOWN OF NEWMARKET</b>			
PROJECT TITLE <b>COSTCO BUSINESS CENTRE</b>			
SHEET TITLE <b>TREE PRESERVATION DETAILS</b>			
CONSULTANT <b>wsp</b>			
PETER McNAMARA ISA Certified Arborist ON: 1145A			
DESIGNED	JD	DRAWN	JD
SCALE	1:200	DATE	NOVEMBER 2024
PROJECT NUMBER	211-07806-00-P01	DWG. NUMBER	TP5