

- LEGEND:
- T000** TREE INVENTORY NUMBER - TREE TO BE PRESERVED/RETAINED
 - T000** TREE INVENTORY NUMBER - TREE TO BE PRESERVED WITH INJURY
 - T000** TREE INVENTORY NUMBER - TREE TO BE REMOVED
 - SURVEYED TREE LOCATION
 - ▲ INDIVIDUAL TREE TO BE PRESERVED WITH INJURY
 - ⊗ INDIVIDUAL TREE TO BE REMOVED DUE TO PROPOSED CONSTRUCTION
 - TREE PROTECTION ZONE (TPZ) FOR TREE LOCATED WITHIN YORK REGIONAL ROAD ALLOWANCE
 - APPROXIMATE DRIPLINE OF TREE CANOPY
 - ▨ ENCROACHMENT WITHIN THE TPZ
 - TREE PRESERVATION FENCE
 - - - PROPERTY BOUNDARY
 - - - TREE INVENTORY BOUNDARY

0	ISSUED FOR SPA	JD	2024-12-12	PM
No.	REVISIONS TO DRAWING	BY	DATE	APPR

ALL PREVIOUS ISSUES OF THIS DRAWING ARE SUPERSEDED

CLIENT

COSTCO WHOLESALE

MUNICIPALITY

TOWN OF NEWMARKET

PROJECT TITLE

COSTCO BUSINESS CENTRE

SHEET TITLE

TREE PRESERVATION PLAN

CONSULTANT

wsp

DESIGNED: JD DRAWN: JD CHECKED: PM

SCALE: 1:200 DATE: NOVEMBER 2024

PROJECT NUMBER: 211-07806-00-P01 DWG. NUMBER: TP1

1 TREE PRESERVATION PLAN
1:200

FILE NAME: C:\Users\CAJ04041\My Documents\Projects\16364\Newmarket_Business_Centre_TP.dwg; TP-1; PRINTED ON: Tuesday, 12/10/2024

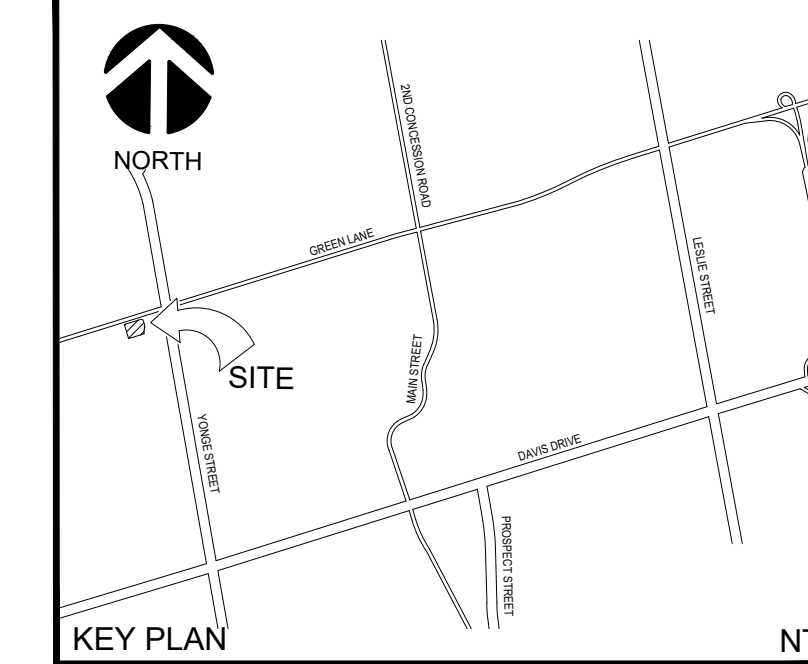

KEY PLAN NTS

- LEGEND:
- T000** TREE INVENTORY NUMBER - TREE TO BE PRESERVED/RETAINED
 - T000** TREE INVENTORY NUMBER - TREE TO BE PRESERVED WITH INJURY
 - T000** TREE INVENTORY NUMBER - TREE TO BE REMOVED
 - SURVEYED TREE LOCATION
 - INDIVIDUAL TREE TO BE PRESERVED WITH INJURY
 - INDIVIDUAL TREE TO BE REMOVED DUE TO PROPOSED CONSTRUCTION
 - TREE PROTECTION ZONE (TPZ) FOR TREE LOCATED WITHIN YORK REGIONAL ROAD ALLOWANCE
 - APPROXIMATE DRIPLINE OF TREE CANOPY
 - ENCROACHMENT WITHIN THE TPZ
 - TREE PRESERVATION FENCE
 - PROPERTY BOUNDARY
 - TREE INVENTORY BOUNDARY

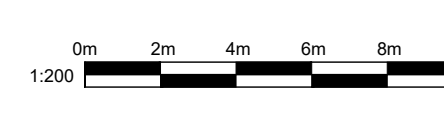
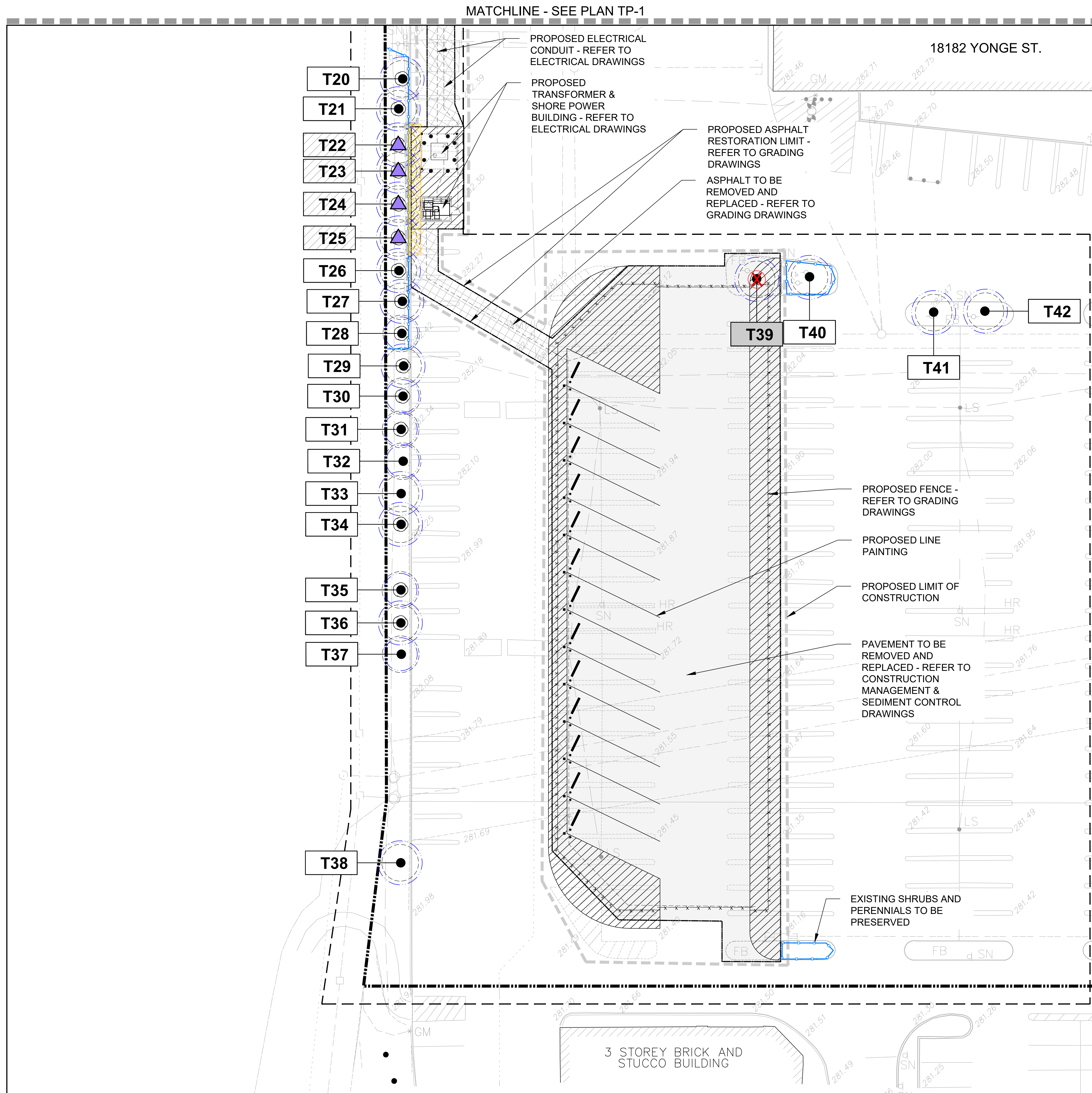

2 TREE PRESERVATION PLAN
1:200

0	ISSUED FOR SPA	JD	2024-12-12	PM
No.	REVISIONS TO DRAWING	BY	DATE	APPR

ALL PREVIOUS ISSUES OF THIS DRAWING ARE SUPERSEDED

CLIENT
COSTCO WHOLESALE

MUNICIPALITY
TOWN OF NEWMARKET

PROJECT TITLE
COSTCO BUSINESS CENTRE

SHEET TITLE
TREE PRESERVATION PLAN

CONSULTANT
wsp

PETER McNAMARA
ISA Certified Arborist
ON: 11424

DESIGNED	JD	DRAWN	JD	CHECKED	PM
SCALE	1:200	DATE	NOVEMBER 2024		
PROJECT NUMBER	211-07806-00-P01		DWG. NUMBER	TP2	

FILE NAME: C:\Users\CAOJ044\1\Projects\211-07806-00-P01\Temp\MapPublic_16364\Newmarket_Business_Centre_TP.dwg; TP-2 PRINTED ON: Tuesday, 12/10/2024

Tree #	Botanical Name	Common Name	Qty	DBH (cm)	Tree Condition			Dripline Radius (m)	Tree Location / Applicable By-law	Address	Tree Protection Zone	Recommendation	Comments - Removal / Preservation
					TI	CS	CV						
Costco Wholesale - 18182 Yonge St. Newmarket													
T1	<i>Picea pungens</i>	Blue Spruce	1	31	G	G	G-F	3.5	Private	18182 Yonge St.	2.4	Preserve - TPZ Encroachment w/ no Injury	Lower deadwood approx. 15%. Pruned from light pole.
T2	<i>Picea pungens</i>	Blue Spruce	1	31	G	G	G	3.5	Private	18182 Yonge St.	2.4	Preserve - TPZ Encroachment w/ no Injury	
T3	<i>Picea pungens</i>	Blue Spruce	1	32	G	F	F	3.5	Private	18182 Yonge St.	2.4	Preserve - TPZ Encroachment w/ no Injury	Deadwood approx. 15-20%. Brown needles. Secondary, smaller leader.
T4	<i>Quercus robur 'fastigiata'</i>	Columnar Oak	1	22	G	G	G	3.0	Private	18182 Yonge St.	2.4	Preserve - TPZ Encroachment w/ no Injury	Multi-stemmed at base.
T5	<i>Quercus robur 'fastigiata'</i>	Columnar Oak	1	19	G	G	G	3.0	Private	18182 Yonge St.	2.4	Preserve - TPZ Encroachment w/ no Injury	
T6	<i>Acer rubrum</i>	Red Maple	1	5	F	F	G	2.0	Private	18182 Yonge St.	1.8	Preserve - TPZ Encroachment w/ no Injury	Injury at base. Witches Broom.
T7	<i>Acer rubrum</i>	Red Maple	1	5	G	F	G	2.0	Private	18182 Yonge St.	1.8	Preserve - TPZ Encroachment w/ no Injury	Witches Broom.
T8	<i>Acer rubrum</i>	Red Maple	1	5	G-F	F	G	2.0	Private	18182 Yonge St.	1.8	Preserve - TPZ Encroachment w/ no Injury	Buried root flare.
T9	<i>Quercus robur 'fastigiata'</i>	Columnar Oak	1	17	G	G	G	2.5	Private	18182 Yonge St.	2.4	Preserve - TPZ Encroachment w/ no Injury	
T10	<i>Quercus robur 'fastigiata'</i>	Columnar Oak	1	18,15	G	G	G	2.5	Private	18182 Yonge St.	2.4	Preserve - TPZ Encroachment w/ no Injury	
T11	<i>Quercus robur 'fastigiata'</i>	Columnar Oak	1	22	G	G	G	2	Private	18182 Yonge St.	2.4	Preserve - TPZ Encroachment w/ no Injury	
T12	<i>Quercus robur 'fastigiata'</i>	Columnar Oak	1	7	G	G	G	1.5	Private	18182 Yonge St.	1.8	Remove	Buried root flare.
T13	<i>Quercus robur 'fastigiata'</i>	Columnar Oak	1	7	G	G	G	1.5	Private	18182 Yonge St.	1.8	Remove	Buried root flare.
T14	<i>Quercus robur 'fastigiata'</i>	Columnar Oak	1	6	G	G	G	1.5	Private	18182 Yonge St.	1.8	Remove	Buried root flare.
T15	<i>Quercus robur 'fastigiata'</i>	Columnar Oak	1	6	G	G	G	1.5	Private	18182 Yonge St.	1.8	Remove	Buried root flare.
T16	<i>Quercus robur 'fastigiata'</i>	Columnar Oak	1	22	G	G	G	2.5	Private	18182 Yonge St.	2.4	Preserve - TPZ Encroachment w/ no Injury	
T17	<i>Quercus robur 'fastigiata'</i>	Columnar Oak	1	15,10	G	G	G	2.5	Private	18182 Yonge St.	2.4	Preserve - TPZ Encroachment w/ no Injury	
T18	<i>Quercus robur 'fastigiata'</i>	Columnar Oak	1	19	G	G	G	2	Private	18182 Yonge St.	2.4	Preserve - TPZ Encroachment w/ no Injury	
T19	<i>Quercus robur 'fastigiata'</i>	Columnar Oak	1	19	G	G	G	2	Private	18182 Yonge St.	2.4	Preserve - TPZ Encroachment w/ no Injury	
T20	<i>Quercus robur 'fastigiata'</i>	Columnar Oak	1	15,11	G	G	G	2	Private	18182 Yonge St.	2.4	Preserve - TPZ Encroachment w/ no Injury	Multiple leaders.
T21	<i>Quercus robur 'fastigiata'</i>	Columnar Oak	1	16	G	G	G	2	Private	18182 Yonge St.	2.4	Preserve - TPZ Encroachment w/ no Injury	Deadwood approx. 10%
T22	<i>Quercus robur 'fastigiata'</i>	Columnar Oak	1	18	G	G	G	2	Private	18182 Yonge St.	2.4	Preserve - With injury	Injury will be mitigated through air-spade mitigation.
T23	<i>Quercus robur 'fastigiata'</i>	Columnar Oak	1	16	G	G	G	2	Private	18182 Yonge St.	2.4	Preserve - With injury	Deadwood approx. 10%. Injury will be mitigated through air-spade mitigation.
T24	<i>Quercus robur 'fastigiata'</i>	Columnar Oak	1	10,8,8	G	G	G	2	Private	18182 Yonge St.	2.4	Preserve - With injury	Injury will be mitigated through air-spade mitigation.
T25	<i>Quercus robur 'fastigiata'</i>	Columnar Oak	1	10,10	G	G	G	2	Private	18182 Yonge St.	2.4	Preserve - With injury	Deadwood approx. 10%. Injury will be mitigated through air-spade mitigation.
T26	<i>Quercus robur 'fastigiata'</i>	Columnar Oak	1	12	G	G	G	2	Private	18182 Yonge St.	2.4	Preserve - TPZ Encroachment w/ no Injury	Deadwood approx. 5%
T27	<i>Quercus robur 'fastigiata'</i>	Columnar Oak	1	10,10,9	G	G	G	2	Private	18182 Yonge St.	2.4	Preserve - TPZ Encroachment w/ no Injury	
T28	<i>Quercus robur 'fastigiata'</i>	Columnar Oak	1	9,8,8	G	G	G	2	Private	18182 Yonge St.	1.8	Preserve	Full TPZ to be preserved.
T29	<i>Quercus robur 'fastigiata'</i>	Columnar Oak	1	12,10	G	G-F	G	2	Private	18182 Yonge St.	2.4	Retain	Small broken limbs lower canopy.
T30	<i>Quercus robur 'fastigiata'</i>	Columnar Oak	1	9,7	G	G	G	2	Private	18182 Yonge St.	1.8	Retain	
T31	<i>Quercus robur 'fastigiata'</i>	Columnar Oak	1	10	G	G	G	2	Private	18182 Yonge St.	1.8	Retain	Lower canopy pruned from parking.
T32	<i>Quercus robur 'fastigiata'</i>	Columnar Oak	1	9,9,8	G	G	G	2	Private	18182 Yonge St.	1.8	Retain	Lower canopy pruned from parking.
T33	<i>Quercus robur 'fastigiata'</i>	Columnar Oak	1	11,9,9	G	G	G	2	Private	18182 Yonge St.	2.4	Retain	
T34	<i>Quercus robur 'fastigiata'</i>	Columnar Oak	1	11	G	G	G-F	2	Private	18182 Yonge St.	2.4	Retain	Deadwood approx. 15%. Canopy thinner than others.
T35	<i>Quercus robur 'fastigiata'</i>	Columnar Oak	1	9,9,9	G-F	G	G	2	Private	18182 Yonge St.	1.8	Retain	Injury lower trunk.
T36	<i>Quercus robur 'fastigiata'</i>	Columnar Oak	1	15,10	G	G	G	2	Private	18182 Yonge St.	2.4	Retain	
T37	<i>Quercus robur 'fastigiata'</i>	Columnar Oak	1	10	G	G	G	2	Private	18182 Yonge St.	1.8	Retain	Pruned from parking.
T38	<i>Acer rubrum</i>	Red Maple	1	13	G-F	G	F	2	Private	18182 Yonge St.	2.4	Retain	20% deadwood. Decay at base.
T39	<i>Gleditsia tricanthos</i>	Honey Locust	1	13	G	G	G	2	Private	18182 Yonge St.	2.4	Remove	Small injury mid-trunk.
T40	<i>Gleditsia tricanthos</i>	Honey Locust	1	12	G	G-F	G	2	Private	18182 Yonge St.	2.4	Preserve	Full TPZ to be preserved.
T41	<i>Gleditsia tricanthos</i>	Honey Locust	1	11	G	G	G	2	Private	18182 Yonge St.	2.4	Retain	Root flare present.
T42	<i>Gleditsia tricanthos</i>	Honey Locust	1	11	G	G	G	2	Private	18182 Yonge St.	2.4	Retain	Root flare present.
Costco Wholesale - Green Lane West, Newmarket													
T43	<i>Acer tataricum</i>	Tatarian Maple	1	5	G	G	G	1.5	Region	Green Ln. W	2.4	Preserve - With injury	Injury will be mitigated through air-spade mitigation.
T44	<i>Acer tataricum</i>	Tatarian Maple	1	6	G	G	G	1.5	Region	Green Ln. W	2.4	Preserve - With injury	Injury will be mitigated through air-spade mitigation.
T45	<i>Acer tataricum</i>	Tatarian Maple	1	5	G	G	G	1.5	Region	Green Ln. W	2.4	Preserve - With injury	Injury will be mitigated through air-spade mitigation.

TREE PRESERVATION TABLE COLOUR LEGEND

- TREE TO BE RETAINED
- TREE TO BE PRESERVED
- TREE TO BE PRESERVED - TPZ ENCROACHMENT WITH NO INJURY
- TREE TO BE PRESERVED - TPZ ENCROACHMENT WITH INJURY
- TREE TO BE REMOVED

TREE PRESERVATION TABLE LEGEND

Tree Assessment Criteria:

- Trunk Integrity (T.I.): this is an assessment of the trunk for any defects or weaknesses. It is measured on a scale of poor, fair, good.
- Canopy Structure (C.S.): this is an assessment of the scaffold branches, unions and the canopy of the tree. This is measured on a scale of poor, fair, good.
- Canopy Vigour (C.V.): this is an assessment of the health of the tree and assess the amount of deadwood and the live growth in the crown as compared to a 100% healthy tree. The size, colour and amount of foliage are also considered in this category. This is measured on a scale of poor, fair, good.

Tree Condition:

- G: Good - tree displays less than 15% deficiency / defect within the given tree assessment criteria (T.I,CS,CV)
- F: Fair - tree displays 15-50% deficiency / defect within the given tree assessment criteria (T.I,CS,CV)
- P: Poor - tree displays greater than 40% deficiency / defect within the given tree assessment criteria (T.I,CS,CV)
- D: Dead - tree displays 100% deficiency / defect within the canopy vigour tree assessment criteria

Recommendation:

- Retain: tree is in good condition and will not be impacted by construction / grading as the tree is more than 6m from the limits of work.
- Remove: tree is either in poor condition or dead or will be significantly impacted by grading and construction limits and will not survive.

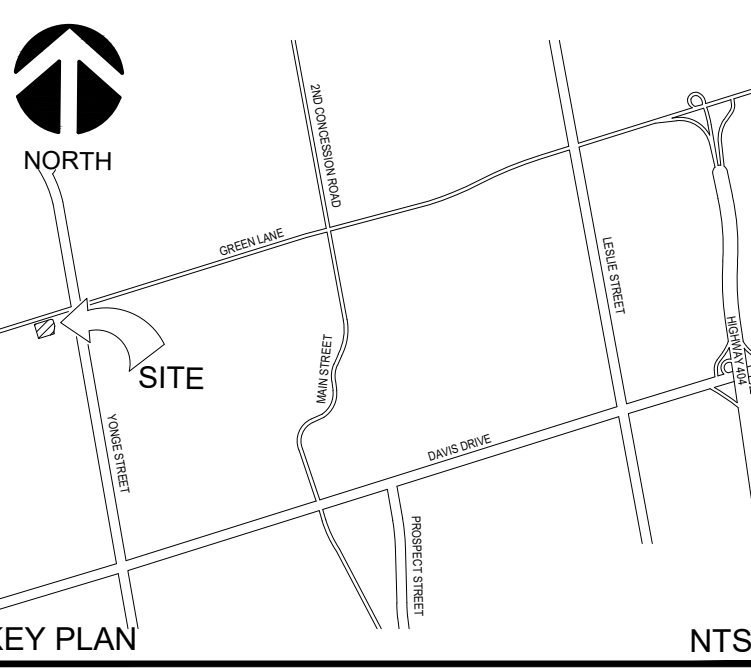

KEY PLAN NTS

0	ISSUED FOR SPA	JD	2024-12-12	PM
No.	REVISIONS TO DRAWING	BY	DATE	APPR

ALL PREVIOUS ISSUES OF THIS DRAWING ARE SUPERSEDED



MUNICIPALITY: TOWN OF NEWMARKET

PROJECT TITLE: COSTCO BUSINESS CENTRE

SHEET TITLE: TREE PRESERVATION TABLES

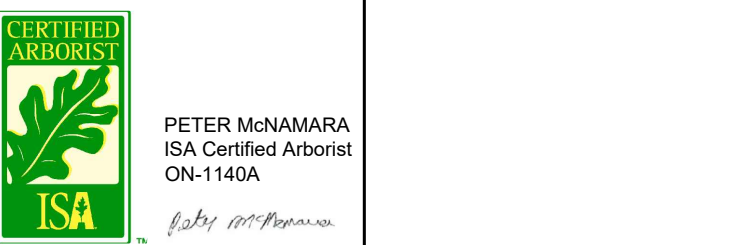

DESIGNED: JD DRAWN: JD CHECKED: PM

SCALE: 1:200 DATE: NOVEMBER 2024

PROJECT NUMBER: 211-07806-00-P01 DWG. NUMBER: TP3

